

# FOOT PEDAL VALVE(5/2 WAY)

## 4F SERIES

### Symbol

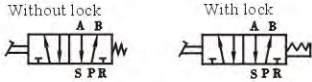

### Specification

Item\Type	4F210-08	4F210-08L	4F210-08G	4F210-08LG
Fluid	Air (to be filtered by 40 μm filter element)			
Operating	Direct acting			
Port size	In=Out= 1/4"			
Pressure range	0-8.0bar (0-0.8MPa)(0-114Psi)			
Temperature ℃	-5-60			
Lubrication	Not required			

\*Note: PT, NPT, BSPP Thread are available

### Ordering code

4F210 — 08 L

Port size

08:1/4"

Model

4F: 5 port 2 position foot pedal valve

Note

Blank: Standard

L: With lock

G: With guard

LG: With lock and guard

### Inner structure

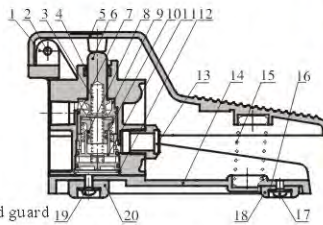

NO.	Item	NO.	Item
1	Pin	11	Bottom cover
2	Screever	12	Ceclip
3	Spring	13	Silencer
4	E-ring	14	Base
5	Pedal	15	Pedal spring
6	Spool	16	Washer
7	O-ring	17	Screever
8	O-ring	18	Base pad
9	Front cover	19	Screever
10	Piston	20	Base pad

Note: Lockable type should be added lubricating grease periodically to ensure the regular work of machine

### Dimensions

4F210-08

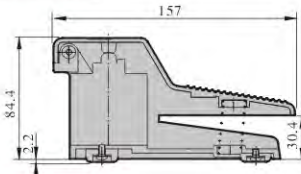

4F210-08L

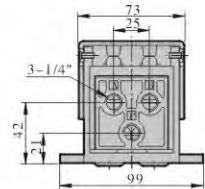
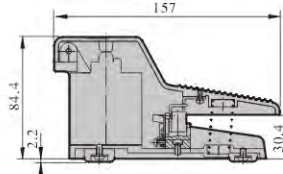

4F210-08G

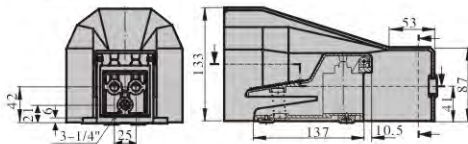

4F210-08LG

