

## The 9/32" flow EFC12 Series

couplings feature a high efficiency valve design that provides a greater flow capability than any other coupling its size. Chemically resistant polypropylene material makes it ideal for harsh environments. The EFC12 Series adds a bulkhead panel mount option for tight seals against tank walls and drums.

### Features

- High efficiency valve
- Plastic thumb latch
- Polypropylene material
- Compatible

### Benefits

- More flow in a compact size
- Fewer moving parts
- Chemically resistant and gamma sterilizable
- Mates with most APC couplings

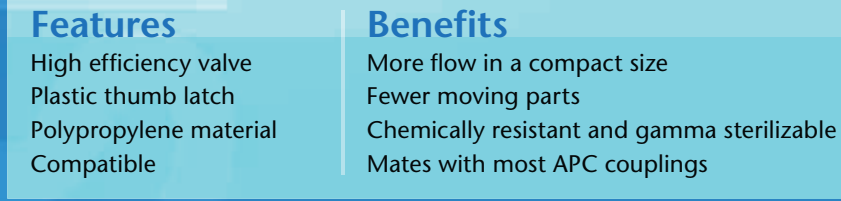

# EFC12 SERIES

## Specifications

**Pressure:** Vacuum to 105 psi, 7.2 bar

**Temperature:** 32°F to 160°F (0°C to 71°C)

### Materials:

- Main components and valves:** Polypropylene
- Thumb latch:** Polypropylene
- Valve spring:** 316 stainless steel
- Panel mount gasket:** EPDM
- External springs:** 302 stainless steel
- O-rings:** EPDM

### Color:

Gray with dark gray latch

### Tubing Sizes:

1/4" and 3/8" ID, 6.4mm and 9.5mm ID

These graphs are intended to give you a general idea of the performance capabilities of each product line. The shaded area of each graph represents the operating range of the product family, i.e., upper and lower values are shown. Therefore, depending on the exact coupling configurations selected, you can reasonably expect values to fall within the shaded area.

EFC12 Air Flow, 100 psig Inlet Pressure

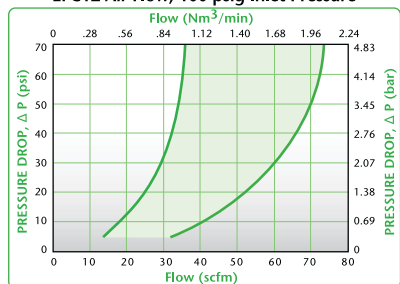

EFC12 Water Flow

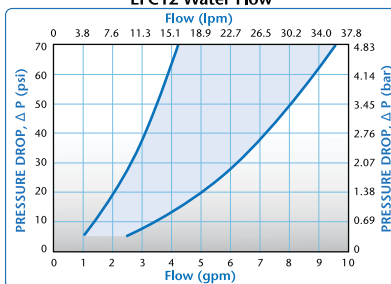

EFC12 Pressure Range

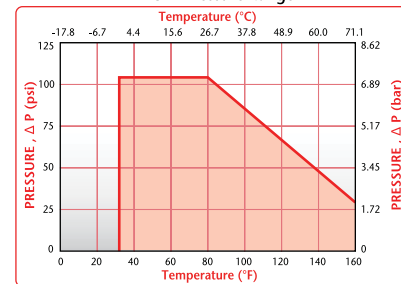

## Liquid Flow Rates

### Liquid Flow Rate Information for Couplings

The chart below shows the flow rate for Colder couplings. Each coupling was tested with water at 70°F (21°C). To determine flow rates for specific coupling configurations use the formula below.

### C<sub>v</sub> Values for EFC12 Couplings

BODIES	EFC 22412	EFCD 22412	EFC 22612	EFCD 22612	EFC 23412	EFCD 23412	EFC 23612	EFCD 23612	EFC 24412	EFCD 24412
EFC10412	0.51	0.51	0.51	0.51	0.50	0.45	0.50	0.50	0.51	0.51
EFC10612	0.61	0.51	1.13	0.72	0.50	0.45	0.81	0.69	0.51	0.72
EFC16412	0.51	0.51	0.51	0.51	0.50	0.45	0.50	0.50	0.51	0.51
EFC16612	0.61	0.51	1.13	0.72	0.50	0.45	0.81	0.69	0.51	0.72
EFC17412	0.51	0.51	0.51	0.51	0.50	0.45	0.50	0.50	0.51	0.51
EFC17612	0.61	0.51	1.13	0.72	0.50	0.45	0.81	0.69	0.51	0.72

$$Q = C_v \sqrt{\frac{\Delta P}{S}}$$

- Q = Flow rate in gallons per minute
- C<sub>v</sub> = Average coefficient across various flow rates (see chart)
- ΔP = Pressure drop across coupling (psi)
- S = Specific gravity of liquid

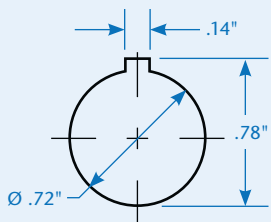

EFC Series  
 Gasket Thickness: .06"  
 Mounting Hole: .720" diameter  
 Coupling Spacing: 1.25" min.  
 Greenlee® 720 Keyway Punch and  
 730BB-3/4 Hole Punch.

COUPLING BODIES	PANEL OPENING	MAX. PANEL THICKNESS	MIN. PANEL THICKNESS
	see drawing	.25	.03



PANEL NUT HEX	PANEL NUT THREAD
13/16	11/16-24UNF

## Product Dimensions

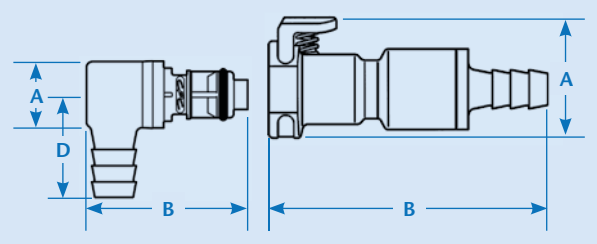

A = Height/Diameter  
 B = Total Length (including valve)  
 D = Elbow Radial Length

## Coupling Bodies

### POLYPROPYLENE

TERMINATION	THREAD SIZE	SHUTOFF	A	B
IN-LINE	1/4" NPT	EFCD10412	.93	2.29
PIPE THREAD	3/8" NPT	EFCD10612	.93	2.29

TERMINATION	TUBING SIZE	METRIC EQ.	SHUTOFF	A	B
BULKHEAD	1/4" ID	6.4mm ID	EFCD16412	.93	2.23
PANEL MOUNT	3/8" ID	9.5mm ID	EFCD16612	.93	2.23

TERMINATION	TUBING SIZE	METRIC EQ.	SHUTOFF	A	B
IN-LINE	1/4" ID	6.4mm ID	EFCD17412	.93	2.23
HOSE BARB	3/8" ID	9.5mm ID	EFCD17612	.93	2.23



## Coupling Inserts

### POLYPROPYLENE

TERMINATION	THREAD SIZE	SHUTOFF	A	B
IN-LINE	1/4" NPT	EFCD24412	.72	1.77
PIPE THREAD	3/8" NPT	EFCD24612	.72	1.77

TERMINATION	TUBING SIZE	METRIC EQ.	STRAIGHT THRU	SHUTOFF	A	B
IN-LINE	1/4" ID	6.4mm ID	EFC22412	EFCD22412	.60/.72	1.33/2.08
HOSE BARB	3/8" ID	9.5mm ID	EFC22612	EFCD22612	.60/.72	1.33/1.90

TERMINATION	TUBING SIZE	METRIC EQ.	STRAIGHT THRU	SHUTOFF	A	B	D
ELBOW	1/4" ID	6.4mm ID	EFC23412	EFCD23412	.63	1.32/1.45	.96
HOSE BARB	3/8" ID	9.5mm ID	EFC23612	EFCD23612	.63	1.32/1.45	.96



## Accessories

PANEL MOUNT GASKET REPLACEMENT	MATERIAL	PART NO.
For sealing panel mount bodies listed above	EPDM	668400



All measurements are in inches (millimeters) unless otherwise noted. Tubing must meet stated inside and outside diameters. Couplings are pictured with valves unless otherwise noted. Straight thru dimension is listed first when two measurements are provided.

COLDER FASTEST EFC12 SERIES 5 M A R T I N